

15^{mm}(1/2'') ~ 30^{mm}(1 1/4'')

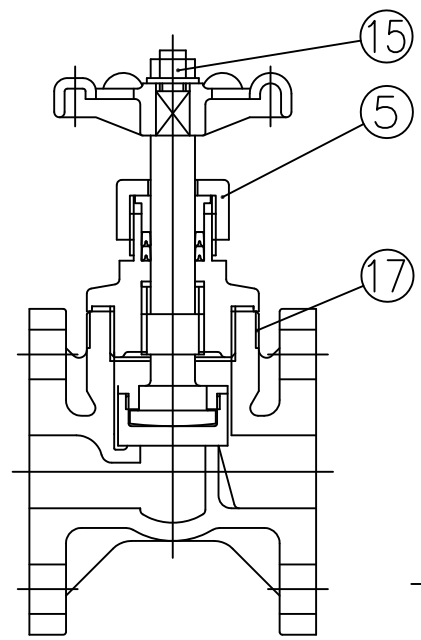

40^{mm}(1 1/2'') · 50^{mm}(2'')

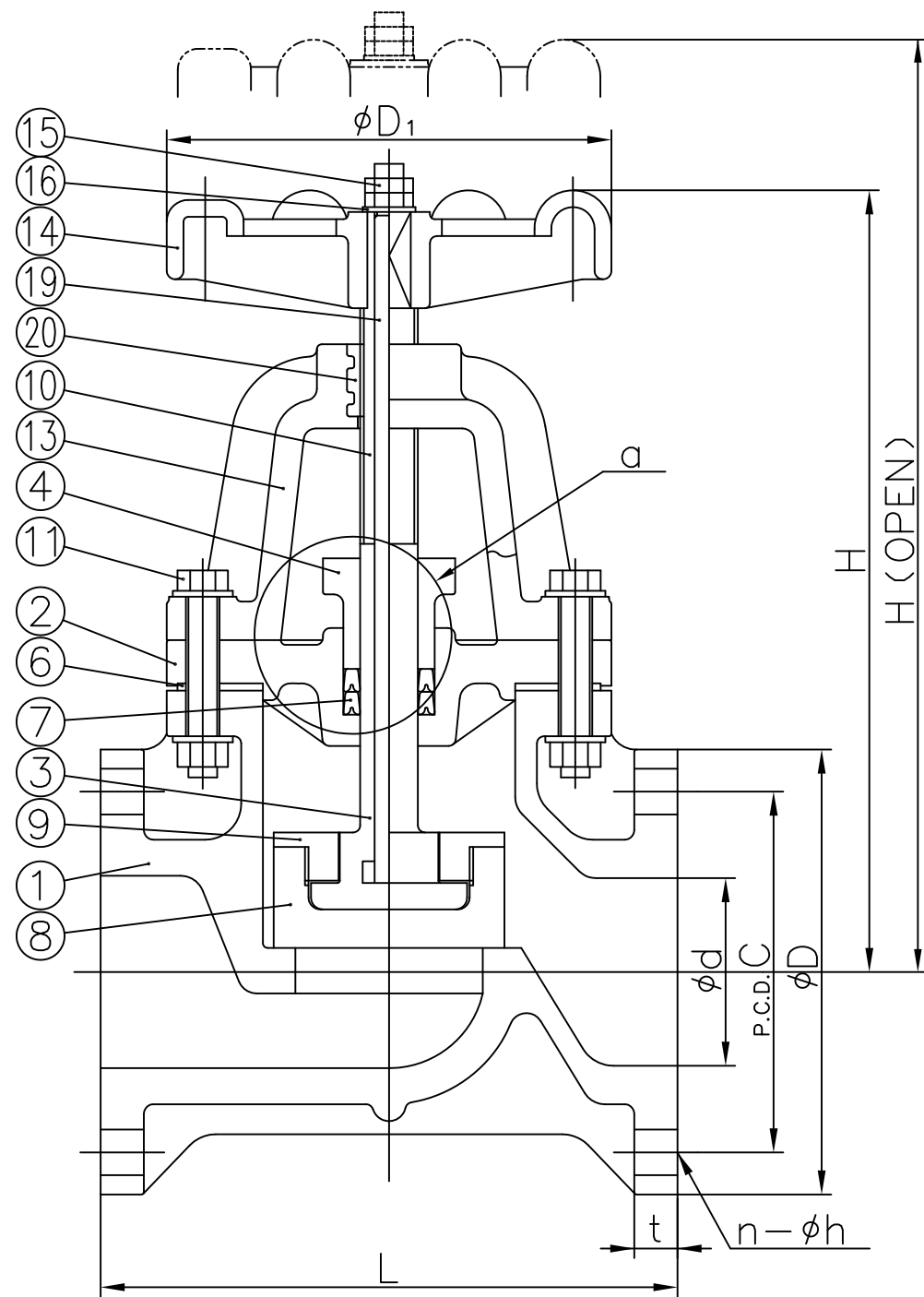
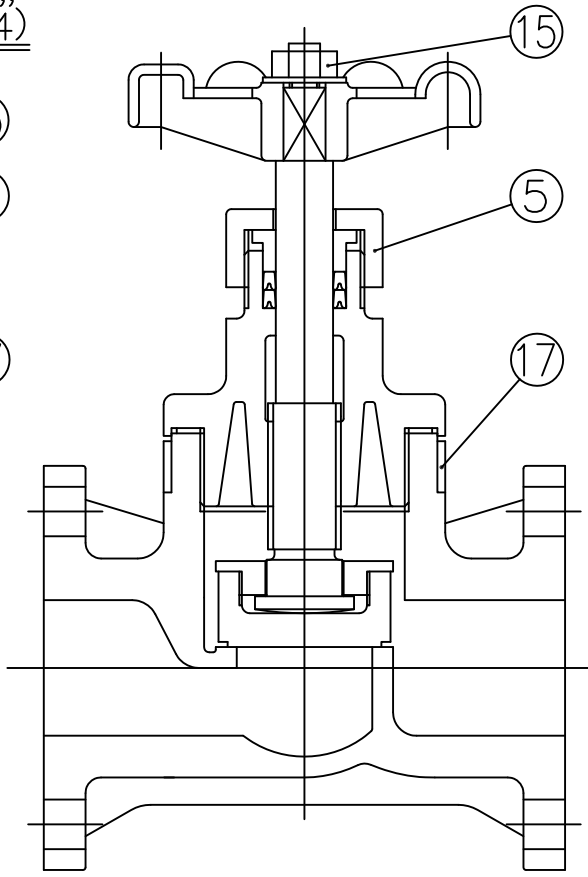

65^{mm}(2 1/2'') ~ 100^{mm}(4'')

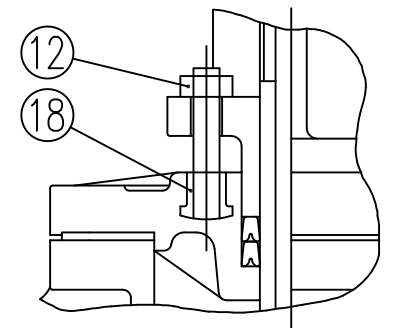

DETAIL OF PART 'a'

DIMENSIONS TABLE

UNIT: mm

NOMINAL SIZE	d	DIN PN10					L	t	D ₁	H	H (OPEN)
		D	C	n	h						
15 ^{mm} 1/2''	18	95	65	4	14	85	12	66	124	132	
20 3/4	24	105	75	4	14	95	14	66	132	140	
25 1	28	115	85	4	14	110	14	91	150	161	
30 1 1/4	37	140	100	4	18	135	16	91	154	167	
40 1 1/2	41	150	110	4	18	190	16	135	210	230	
50 2	52	165	125	4	18	200	16	135	228	252	
65 2 1/2	67	185	145	4	18	220	18	185	310	345	
80 3	78	200	160	8	18	240	18	185	324	359	
100 4	100	220	180	8	18	290	18	185	379	419	

NOTE. The shape and appearance of assembly differ a little with nominal size compared to this drawing.

20	INSERTED METAL	1	BRONZE (BC6)	used for size 65~100 ^{mm}
19	INSERTED METAL OF STEM	1	STEEL (SS400)	used for size 65~100 ^{mm}
18	INSERTED NUT	2	COPPERALLOY (C3604)	used for size 65~100 ^{mm}
17	RING FOR REINFORCING	1	STAINLESS STEEL (SUS304)	used for PP BODY size 15~50 ^{mm}
16	WASHER	1	PVC	used for size 15~50 ^{mm}
		1	STEEL (SS304)	used for size 65~100 ^{mm}
15	NUT (A)	1	PVC	used for size 15~50 ^{mm}
		2	STEEL (SS304)	used for size 65~100 ^{mm}
14	HAND WHEEL	1	P P	
13	SUPPORT OF STEM	1	P P	used for size 65~100 ^{mm}
12	STUD BOLT NUT	2	STAINLESS STEEL (SUS304)	used for size 65~100 ^{mm}
11	BOLT NUT	8	STAINLESS STEEL (SUS304)	used for size 65~100 ^{mm}
10	STEM WITH TRAPEZOID SCREW	1	COPPERALLOY (C3604)	used for size 65~100 ^{mm}
9	STEM HOLDER	1	P P	
8	DISC	1	P P	
7	GLAND PACKING	1set	□ EPDM □ PTFE □ Others	2) In case that GLAND PACKING is PTFE ; EPDM coated with PTFE
6	SHEET GASKET ³⁾	1	□ PVC	1) 65~100 ^{mm} : PP
5	GLAND NUT ²⁾	1	□ PP	2) used for size 15~50 ^{mm}
4	GLAND	1	□ PVC	
3	STEM ¹⁾	1	□ PP	
2	BONNET	1		
1	BODY	1		
No.	DESCRIPTION	No.REQ'D	MATERIAL	REMARKS

STOP VALVE ASS'Y
DIN : FLANGED END
15 mm (1/2'') ~ 100 mm (4'')

DRAWN	E.Enmei	DATE	JUL. 4. 2000	SCALE	~
CHECKED	A.Kuroki	DRAWING No.			
APPROVED	Y.Kuroki	ST-M1001DE			
SPECIAL ORDER No.	ASAHI YUKIZAI CORPORATION				