

In case of PTFE Diaphragm.

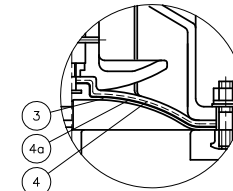

In case of PTFE Diaphragm with Cushion Cover.

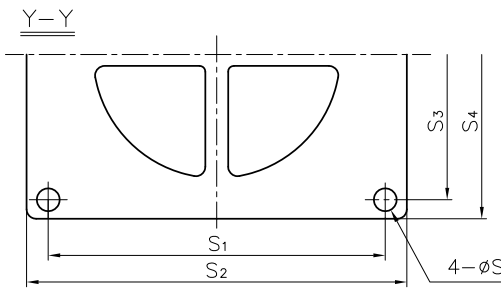

In case of PVDF Body

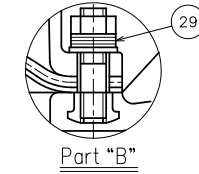

NOTE.

- Diaphragms except EPDM and PTFE are available in FKM, VIFLON-C (FKM-C), VIFLON-F (FKM-F), CSM and NBR when required.
- The shape and appearance of assembly differ a little with nominal size compared to this drawing.

No.	DESCRIPTION	QTY.	MATERIAL	REMARKS
1a	INSERTED NUT	-	STAINLESS STEEL (SUS304) COPPER ALLOY (C3604)	Used for PVDF Body Used for PVC,PP Body
113a	BOLT (F)	4	STAINLESS STEEL (SUS304)	
113	SPACER	1	STEEL (SS400)	Epoxy Coat.
75	BOLT (B)	4	STAINLESS STEEL (SUS304)	
74	O-RING (H)	1	NBR	
73	ACTUATOR	1	CAST IRON (FC250) etc.	Epoxy Coat.
72	STEM (B)	1	STAINLESS STEEL (SUS304)	
71	BONNET (B)	1	CAST ALUMINIUM ALLOY (AC4C)	Epoxy Coat.
56	STAND (A)	1	CAST ALUMINIUM ALLOY (AC4C)	Epoxy Coat.
29	CONICAL SPRING WASHER	-	STAINLESS STEEL (SUS304)	Used for PVDF Body
24	BOLT · NUT (A)	-	STAINLESS STEEL (SUS304)	
23	STUD BOLT · NUT	-	STAINLESS STEEL (SUS304)	
7	COMPRESSOR PIN	1	STAINLESS STEEL (SUS304)	
5	COMPRESSOR	1	Chromized CAST IRON (FC200)	
4a	CUSHION COVER	1	<input type="checkbox"/> Nothing <input type="checkbox"/> PVDF	Used for PTFE Diaphragm
4	CUSHION	1	EPDM	Used for PTFE Diaphragm
3a	INSERTED METAL OF DIAPHRAGM (A)	1	STAINLESS STEEL (SUS304)	
3	DIAPHRAGM	1	<input type="checkbox"/> EPDM <input type="checkbox"/> PTFE <input type="checkbox"/> Others ()	
1	BODY	1	<input type="checkbox"/> PVC <input type="checkbox"/> PP <input type="checkbox"/> PVDF	

DIMENSIONS TABLE

NOMINAL SIZE	d	ANSI Class 150										UNIT:inch										ACTUATOR MODEL				
		D	C	n	h	L	t		D1	D2	l	A	A1	A2	A3	H	H1	S	S1	S2	S3	S4	S5	RETURN BY AUTOMATIC TYPE	RETURN BY MANUAL TYPE	
							U-PVC	PP/PVDF																		
8" 200mm	7.72	13.50	11.75	8	0.88	22.44	1.10	1.26	16.93	18.11	3.74	14.06	3.15	11.54	5.91	31.57	7.05	0.79	15.35	17.32	12.99	14.96	0.91	LTMD-01	LTKD-01	
10	250	9.72	16.00	14.25	12	1.00	26.77	1.18	1.46	21.26	18.11	5.04	14.76	3.15	12.91	6.30	38.15	8.46	0.91	18.50	21.26	15.35	18.11	0.98	LTMD-02	LTKD-02

ITEM	DIAPHRAGM VALVE (TYPE 72) ELECTRIC ACTUATED S TYPE ASS'Y ANSI Class150 : FLANGED END 8" (200mm) · 10" (250mm)		
DRAWN	M.Iwakiri	DATE	SCALE
CHECKED	H.Kawano	FEB.12.2019	~
APPROVED	K.Koushou	DRAWING No. DF-AE001AE	
SPECIAL ORDER No.	ASAHI YUKIZAI CORPORATION		